

Mr. Coffee®

EST. 1970

© 2016 Sunbeam Products, Inc. doing business as Jarden Consumer Solutions. All rights reserved. Distributed by Sunbeam Products, Inc. doing business as Jarden Consumer Solutions, Boca Raton, Florida 33431.

U.S. 1-800-MR COFFEE (1-800-672-6333) Canada 1-800-667-8623

Visit us at www.mrcoffee.com
You will find exciting and entertaining tips and ideas,
including great recipes!

© 2016 Sunbeam Products, Inc. operando bajo el nombre de Jarden Consumer Solutions. Todos los derechos reservados. Distribuido por Sunbeam Products, Inc. operando bajo el nombre de Jarden Consumer Solutions, Boca Raton, Florida 33431.

Visítenos en www.mrcoffee.com
Ahí encontrará consejos e ideas excitantes y entretenidos,
¡incluyendo excelentes recetas!

Printed in China/Impreso en China
BVMC-ECMP1000_BVMC-ECMP1001_16ESM1

P.N.180027 Rev. A
GCDS-MRC43299-BB

User Manual / Manual del Usuario

Mr. Coffee®

EST. 1970

café barista

Espresso, Cappuccino and Latte Maker
Para preparar café espresso, capuchino y latte

BVMC-ECMP1000 Series



www.mrcoffee.com

IMPORTANT SAFEGUARDS

When using electrical appliances, basic safety precautions should always be followed to reduce the risk of fire, electric shock and/or injury to persons, including the following:

1. **READ ALL INSTRUCTIONS BEFORE USING THE APPLIANCE.**
2. Do not touch hot surfaces. Use handles or knobs.
3. To protect against electric shock, do not immerse cord, plug or appliance in water or other liquids.
4. Unplug unit from electrical outlet when not in use and before cleaning. Allow it to cool before putting on or taking off parts and before cleaning it.
5. Do not operate any appliance with a damaged cord or plug or after the appliance malfunctions or has been damaged in any manner. Return this appliance only to the nearest Authorized MR. COFFEE® Service Center for examination, repair or adjustment. Do not attempt to replace or splice a damaged cord.
6. The use of an accessory not recommended by the appliance manufacturer for use with this appliance may result in fire, electric shock or injury to persons.
7. Do not use outdoors or for commercial purposes.
8. Do not let cord hang over edge of table or countertop or touch hot surfaces.
9. Do not place this appliance on or near a hot gas or electric burner or in a heated oven.
10. To disconnect, press the switch located on the side of the unit to the off position "O" and then remove plug from outlet.
11. Do not use appliance for anything other than its intended use.
12. Use on a hard, flat level surface only, to avoid interruption of airflow underneath the appliance.
13. Always be sure to place the water reservoir back on the unit tightly with the lid closed and water filled up to, but not surpassing, the MAX line.
14. Do not remove the porta-filter while brewing coffee. Please make sure the three lights are on before you remove the porta-filter to make additional coffee. Caution should also be taken while removing the porta-filter since the metal parts will be hot. Please make sure to hold it by the handle and to use the filter retention clip to dispose the grounds. Caution should be taken when moving unit with hot liquids.
15. Do not remove the water reservoir or milk reservoir until the unit has stopped brewing and/or frothing.
16. This appliance is not to be used by children or by persons with reduced physical, sensory or mental capabilities.
17. Close supervision is necessary when any appliance is used near children. Children should not play with the appliance.

SAVE THESE INSTRUCTIONS

THIS UNIT IS FOR HOUSEHOLD USE ONLY.

POWER CORD INSTRUCTIONS

1. A short power supply cord is provided to reduce the hazards resulting from becoming entangled in or tripping over a longer cord.
2. An extension cord may be purchased and used if care is exercised in its use.
3. If an extension cord is used, the marked electrical rating of the extension cord must be at least as great as the electrical rating of the appliance. The resulting extended cord must be arranged so that it will not drape over a countertop or tabletop where it can be pulled on by children or tripped over accidentally.

POLARIZED PLUGS



This appliance has a polarized plug, (one blade is wider than the other). As a safety feature to reduce the risk of electrical shock, this plug is intended to fit in a polarized outlet only one way. If the plug does not fit fully in the outlet, reverse the plug. If it still does not fit, contact a qualified electrician. Do not attempt to defeat this safety feature or modify the plug in any way. If the plug fits loosely into the AC outlet or if the AC outlet feels warm do not use that outlet.

CORRECT USE OF GROUND COFFEE FOR ESPRESSO MAKERS

Do not use sugar roasted* ground coffee or sugar roasted coffee beans as these will clog the filter and damage the appliance. If sugar roasted coffee is accidentally used, stop using the unit and bring it to the closest service center for maintenance.

We recommend descaling the machine periodically to keep it in good working condition. Contact us toll-free at the Consumer Service Department, 1-800-MR COFFEE (1-800-672-6333) to learn about this process.

(*) GROUND WITH SUGAR

TABLE OF CONTENTS

Important Safeguards	2
Diagram Of Parts	5
Introduction	7
Before Using Your Appliance For The First Time	8
Selecting The Right Coffee	9
Operating Instructions	10
Cleaning Your Mr. Coffee® Café Barista coffee maker	15
Troubleshooting Your Mr. Coffee® Café Barista coffee maker	18
Service And Maintenance	19
Warranty Information	19

DIAGRAM OF PARTS

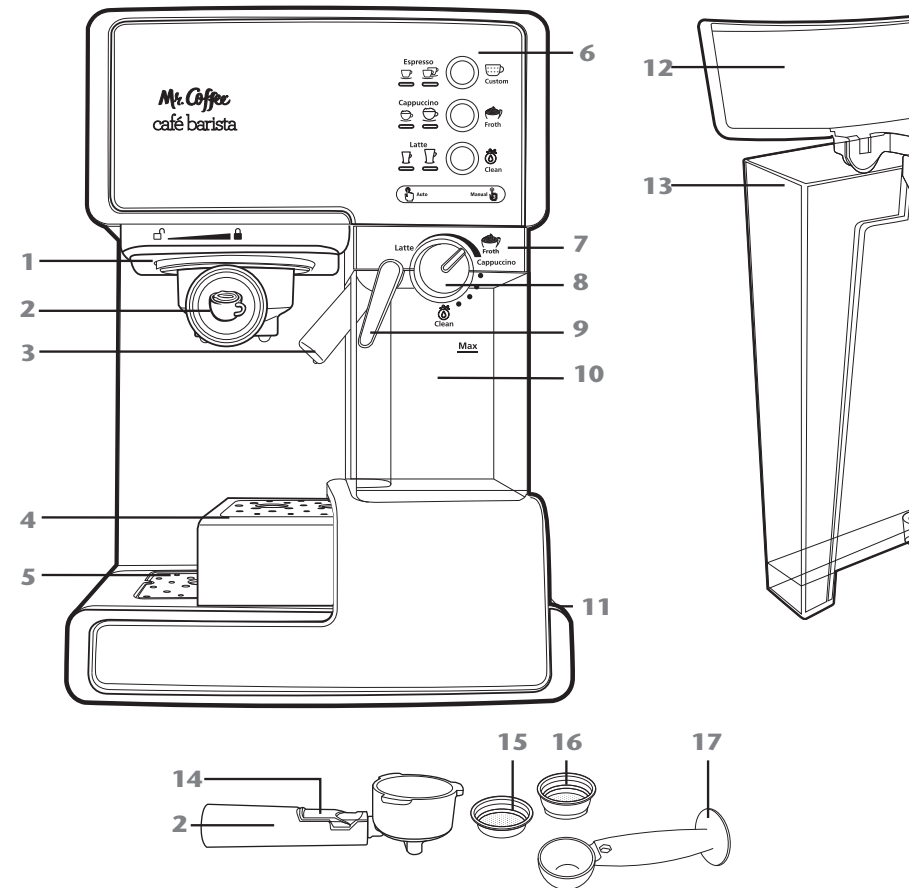

- | | |
|---|--|
| 1. Brew Head | 10. Removable Milk Reservoir |
| 2. Porta-Filter | 11. On/Off Switch "I/O" (see right side of appliance) |
| 3. Frothed Milk Dispensing Tube | 12. Water Reservoir Lid |
| 4. Cup Height Adjusting Tray | 13. Removable Water Reservoir |
| 5. Removable Drip Tray and Lid | 14. Porta-Filter Retention Clip |
| 6. Control Panel (See Understanding the Controls section for more details) | 15. Filter for Single Shot of Espresso (1-Cup) |
| 7. Milk Reservoir Lid | 16. Filter for Double Shot of Espresso (2-Cup) |
| 8. Froth Control Knob | 17. Measuring Scoop/Tamper |
| 9. Frothing Tube Lever | |

Note: E.S.E. Pod Holder Adaptable. Not included with all models. Please visit www.mrcoffee.com for more details.

Control panel

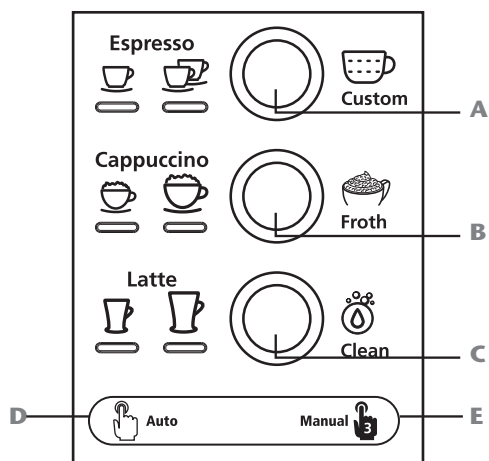

Understanding the Controls

Your control panel is divided into 2 parts. The left side of each button indicates the automatic brewing functions (See D in Figure). The right side indicates the manual function of each button (See E in Figure).

Lights Indicate:

- Button Light Pulses
 - Unit is heating up
 - Unit is brewing/frothing/cleaning
- Button Light Remains Illuminated
 - Unit is ready for use
- Cappuccino and Latte Button Lights do not illuminate
 - Milk Reservoir not fully inserted in unit. Firmly push Milk Reservoir into unit until lights illuminate.
- Icon Lights illuminate
 - Indicates your brew selection
- Button Light Flashes
 - Water Reservoir is empty
 - Function selected before unit is ready

Espresso (Button A):

- Automatic: Select espresso size.
- Manual: Customize the amount of espresso in your beverage.

Cappuccino (Button B):

- Automatic: Select cappuccino size.
- Manual: Customize the amount of frothed milk in your beverage.

Latte (Button C):

- Automatic: Select latte size.
- Manual: The manual function of this button controls the cleaning cycle for the frothed milk dispensing tube.

NOTE: Please read the rest of the instructions before operating the MR. COFFEE® Café Barista (espresso, cappuccino & latte maker).

INTRODUCTION

Congratulations! You have selected the new and innovative Mr. Coffee® Café Barista (espresso, cappuccino & latte maker). This unique appliance has been designed to help you prepare delicious espressos, cappuccinos and lattes quickly, conveniently, and automatically with the touch of a button.

FOR BEST BREW

When using appliance, be sure to use espresso grounds. If grinding beans, be sure to purchase espresso beans.

ESPRESSO

A unique method of coffee brewing in which hot water is forced through finely ground coffee. Popular in Europe, it is a far richer and more full-bodied brew than regular drip coffee. Because of its richness, espresso is usually served in 44 to 59 mL (1.5 to 2 oz.) portions, in demitasse cups.

CAPPUCCINO

A drink made with about 1/3 espresso, 1/3 steamed milk, and 1/3 frothed milk.

LATTE

A drink made with about 1/4 espresso and 3/4 steamed milk.





Please read ALL of the instructions, cautions, notes and warnings included in this instruction manual carefully before you begin to use this appliance. When this unit is used, some parts and accessories get hot and need to cool down. Proper care and maintenance will ensure the long life of the MR. COFFEE® Café Barista and its trouble-free operation. Save these instructions and refer to them often for cleaning and care tips.

BEFORE USING YOUR APPLIANCE FOR THE FIRST TIME

Step 1 - CLEAN THE APPLIANCE

1. Make sure unit is unplugged and the On/Off switch is in the Off position "O".
2. Remove stickers and labels from the unit.
NOTE: remove the red plug found at the base of the water reservoir.
3. Remove and wash the water reservoir, milk reservoir, porta-filter, 2 filters and measuring scoop in a mixture of mild detergent and water. Rinse each thoroughly and place back onto appliance.
NOTE: Porta-filter and water reservoir are NOT dishwasher safe.

Step 2 - PRIME THE UNIT (must be completed prior to first use)

1. Plug unit in and turn unit ON ("I") using the On/Off switch.
2. Fill water reservoir up to the "MAX" level with water and place back on unit.
3. Fill milk reservoir up to the "MAX" level with water and place back on unit. Be sure to firmly push the milk reservoir into place until Cappuccino and Latte buttons illuminate.
4. Place porta-filter in the unit ensuring it is properly locked. For more instructions, refer to the "Placing the Porta-Filter" section on page 11 of this manual.
5. Place a large cup under porta-filter.
6. Aim the tip of the frothed milk dispensing tube inside the cup.
7. Once all 3 lights on the control panel stop pulsing and remain illuminated, press the Espresso button  and hold until the pump starts then release the button. Once the pump starts, let it run until the unit stops automatically or until you see water flow from porta-filter. To stop the process yourself, press the Espresso button  again.
8. If you do not see water flow from porta-filter after unit stops automatically, repeat step 7 until you do.
9. Empty cup and place back under porta-filter.
10. Press the cappuccino button  and hold until pump starts then release it. Once the pump starts, let it run until the unit stops automatically or until you see water flow from the frothed milk dispensing tube. To stop the process yourself, press the Cappuccino button  again.
11. Once step 10 is complete, the 3 control panel lights will remain illuminated indicating that the unit is ready for use.

HOW TO SELECT THE RIGHT CUP

Please make sure to select your cup according to the following chart:

BEVERAGE		AMOUNT
Espresso	Single (☕)	1.25 oz
	Double (☕☕)	2.5 oz
Cappuccino	Single (☕)	6 oz
	Double (☕☕)	10 oz
Latte	Single (☕)	12 oz
	Double (☕☕)	15 oz

NOTE: The total amount of the beverage can vary depending on the type of milk used and Froth Control Knob setting.

SELECTING THE RIGHT COFFEE

THE COFFEE

The coffee should be freshly ground and dark roasted. You may want to try a French or Italian roast ground for espresso. Pre-ground coffee will only retain its flavor for 7 – 8 days, provided it is stored in an airtight container and in a cool, dark area. Do not store in a refrigerator or freezer. Whole beans are recommended to be ground just before use. Coffee beans stored in an airtight container will keep its flavor for up to 4 weeks.

THE GRIND

This is a vital step in the espresso making process if you are grinding your own coffee and takes practice. The coffee must be of a fine grind.

- The correct grind should look like salt.
- If the grind is too fine, the water will not flow through the coffee even under pressure. These grinds look like powder and feel like flour when rubbed between fingers.
- If the grind is too coarse, the water flows through the coffee too fast, preventing a full-flavored extraction.

Be sure to use a quality grinder for uniform consistency. A conical or burr mill grinder is recommended for a consistent and fine espresso grind.

OPERATING INSTRUCTIONS

IMPORTANT: Unit must be primed prior to first use. See page 8.

FILLING THE WATER RESERVOIR

- Lift the removable water reservoir from the unit and fill with fresh water up to the “MAX” line. Do not fill past the “MAX” line. Never use warm or hot water to fill the water reservoir.
- Close the water reservoir lid and place it back in the unit ensuring it fits tightly.

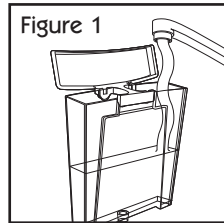

FILLING THE MILK RESERVOIR

If you plan to prepare cappuccino or latte, remove the milk reservoir from the unit. Lift the lid and pour the quantity of cold milk you estimate you will need. Do not fill past the “MAX” line. When done, place the milk reservoir back in the unit ensuring it fits tightly and the Cappuccino and Latte buttons are illuminated or pulsing.

NOTE: Be sure to firmly push Milk Reservoir into unit until Cappuccino and Latte buttons light illuminate/pulse.

NOTE: You can use any type of milk, i.e. whole milk, low fat milk, organic or soy milk.

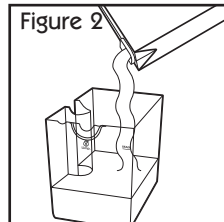

CHOOSING THE FILTER

Select the filter to be used as follows:

- FOR A SINGLE SHOT** – use the filter for a single shot of espresso if using ground coffee.
- FOR A DOUBLE SHOT OR TWO SINGLE SHOTS** – use filter for a double shot.

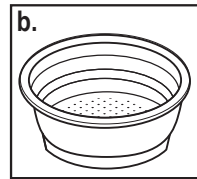
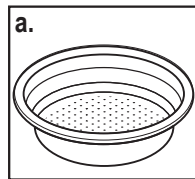

INSERTING THE FILTER

- To insert the selected filter in the porta-filter, make sure to align the notch on the filter with the groove inside the porta-filter.

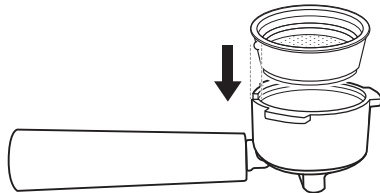

- Turn the filter to the left or right to lock in place. This will help secure the filter in the porta-filter.

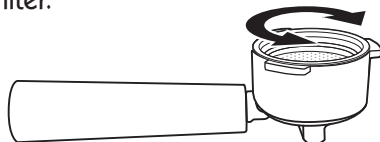

NOTE: To remove and clean the filter, turn filter to the left or right to align the filter notch with the groove inside the porta-filter.

WARNING: Make sure the filter has cooled before attempting to remove the filter.

FILLING WITH COFFEE

- Fill the filter with fresh, fine ground espresso coffee (do not overfill).
- Tamp and compress the ground coffee firmly and evenly. Coffee should be 1/8-inch below top of filter after tamping.
- Clean any excess coffee from the rim to ensure proper fit under brew head and avoid leaks.

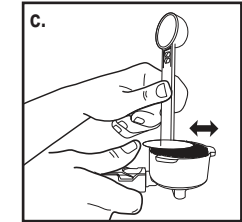
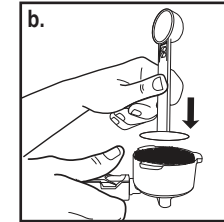
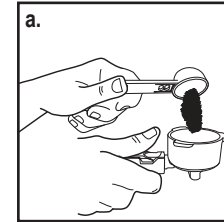

PLACING THE PORTA-FILTER

- Position porta-filter underneath the brew head, attach porta-filter by first moving retainer clip back.
- Position handle so that the handle lines up with the open lock icon “☐” on the unit and fits into the groove.
- Then, slowly turn it to the right until the retention clip is aligned with the closed lock symbol “🔒” on the unit.

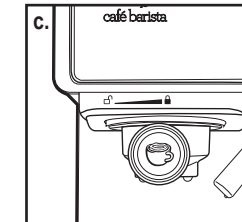
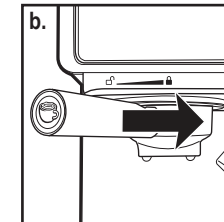
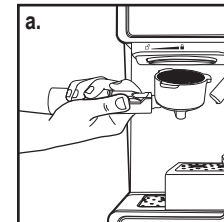

PLACING THE CUP(S)

- Pull out the height adjustment tray if you are using a small “demitasse” cup to brew espresso.
- Keep the height adjustment tray inside its compartment if you are using a larger cup to brew cappuccino.
- Keep the height adjustment tray inside its compartment if you are brewing into a larger cup.

CAUTION: When brewing cappuccino or latte, make sure to adjust the frothing tube lever to aim the frothed milk dispensing tube inside your cup.

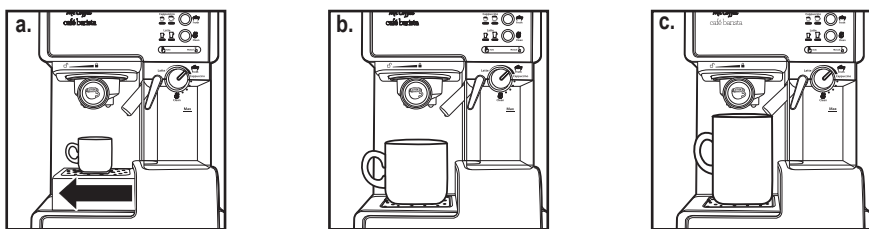

TURNING THE UNIT ON

- Make sure unit is plugged in.
- Turn unit on "I".

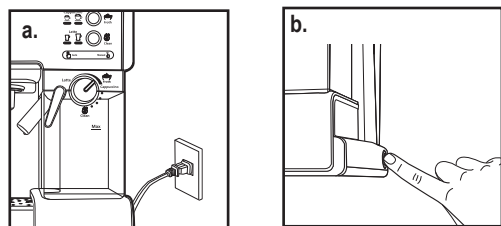

The 3 control panel lights will start pulsing during heating until the brew and steam heaters reach the perfect temperature. Once these lights become solid, the unit is ready to use.

NOTE: It is normal for the Espresso function to be ready before the Cappuccino and Latte functions.

NOTE: If you leave your unit on for 15 minutes without using, your unit will go into sleep mode. Press any button to reactivate.

SELECT THE FUNCTION

PREPARING ESPRESSO

- Press the Espresso Button "Espresso" once to brew one single shot.
- Press the Espresso Button "Espresso" twice to brew a double shot.
- Press and hold the Espresso Button "Espresso" for 3 seconds to customize the brewing to your preference. When done, press the Espresso Button "Espresso" once again to stop brewing. For safety, unit will automatically stop after brewing 5 ounces.

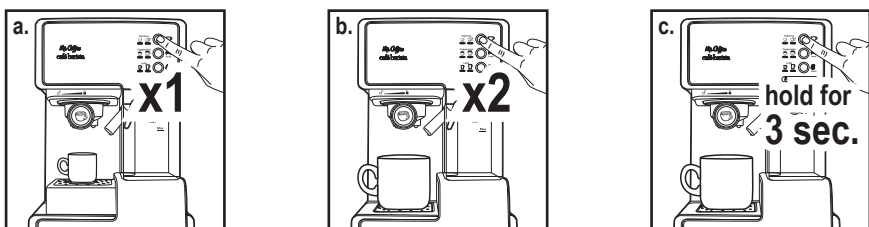

The unit will start brewing the espresso according to your selection. The unit will turn off automatically and the lights will become solid indicating that the cycle has been completed. Your delicious espresso is ready to be enjoyed.

NOTE: To brew less coffee than the preset serving, press the function button to stop the brewing process when the amount of coffee desired is reached.

PREPARING CAPPUCCINO

Prior to preparing your cappuccino, adjust the amount of froth milk according to your preference by turning the Froth Control Knob to the right for more froth and to the left for less froth. For Cappuccino, it is recommended that the Froth Control Knob be turned to the Cappuccino setting.

MORE FROTH

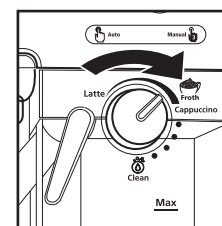

LESS FROTH

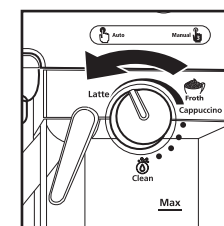

NOTE: The froth intensity can be adjusted during the brewing cycle.

- Press the Cappuccino Button "Cappuccino" once to brew a small cup of cappuccino.
- Press the Cappuccino Button "Cappuccino" twice to brew a large cup of cappuccino.

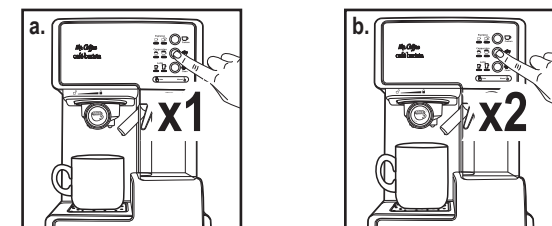

NOTE: For a small cup, use the single shot filter. For a large cup, use the double shot filter.

IMPORTANT: Make sure to clean the Frothed Milk Dispensing Tube after use. See Cleaning instructions on page 15 for instructions.

PREPARING LATTE

Prior to preparing your latte, adjust the amount of froth according to your preference by turning the Froth Control Knob to the right for more froth and to the left for less froth. For Latte, it is recommended that the Froth Control Knob be turned to the Latte setting.

MORE FROTH

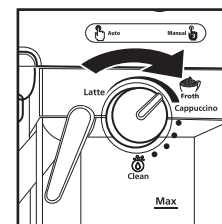

LESS FROTH

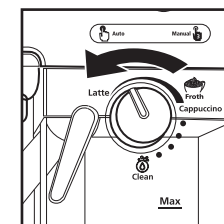

- Press the Latte Button "Latte" once to brew a small cup of latte.
- Press the Latte Button "Latte" twice to brew a large cup of latte.

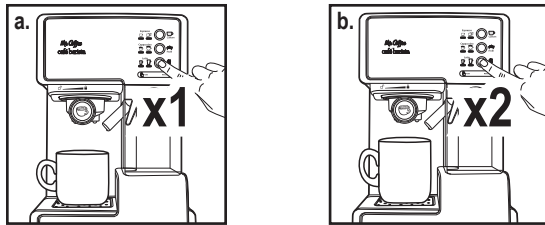

NOTE: For a small cup, use the single shot filter. For a large cup, use the double shot filter.

IMPORTANT: Make sure to clean the Frothed Milk Dispensing Tube after use. See Cleaning instructions on page 15 for instructions.

TO ADD ADDITIONAL FROTHED MILK / FROTH MILK SEPARATELY

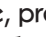
The Mr. Coffee® Café Barista also allows you to manually add more frothed milk to your beverage or froth milk separately. To add more frothed milk to your beverage, place your beverage on the unit and ensure the Frothed Milk Dispensing Tube is aimed towards the center of your cup. Next, Press and Hold the Cappuccino Button “” for 3 seconds and the unit will begin to add more frothed milk. When done, press the Cappuccino Button “” once again to stop the unit. For frothing milk separately, follow the same instructions but place an empty cup on the unit instead. The frothed milk can be used for macchiato, hot chocolate, chai latte, etc.

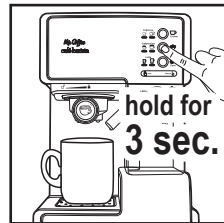



CLEANING YOUR CAFÉ BARISTA COFFEE MAKER

CLEANING THE MILK RESERVOIR AND FROTHED MILK DISPENSING TUBE

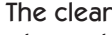

Once you are done preparing your beverage with milk, you can either store the unit's milk reservoir with milk directly in the refrigerator OR completely clean the milk reservoir.

If storing your milk reservoir with milk in refrigerator, follow these cleaning instructions:

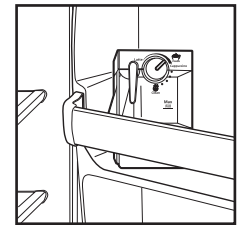
1. Place a large empty cup under the frothing tube and make sure there is water in the water reservoir.
2. Aim the Frothed Milk Dispensing Tube into the empty cup.
3. Adjust the Froth Control Knob to Clean “”.
4. Press and hold the Latte/Clean “” button until pump starts, then release it. The clean function will run for 30 seconds and then stop automatically. To stop the process yourself, press the Latte/Clean button “” again.
5. Once completed, throw the contents in the cup away.
6. The Frothed Milk Dispensing Tube is now clean and the milk reservoir with milk can now be stored in the refrigerator.



If completely cleaning milk reservoir, follow these cleaning instructions:

1. Place a large empty cup under the frothing tube and make sure there is water in the water reservoir.
2. Aim the Frothed Milk Dispensing Tube into the empty cup.
3. Adjust the Froth Control Knob to Clean “”.
4. Press and hold the Latte/Clean “” button until pump starts, then release it. The clean function will run for 30 seconds and then stop automatically. To stop the process yourself, press the Latte/Clean button “” again.
5. Once completed, throw the contents in the cup away.
6. Remove milk reservoir from appliance and discard any remaining milk.
7. Rinse and wash all parts of the milk reservoir container and lid thoroughly with warm soapy water. Rinse and dry well. Do not use abrasive cleaners and scouring pads, as they will scratch the finish. The milk reservoir and lid is also dishwasher safe (top rack).

CLEANING THE PORTA-FILTER, FILTER AND BREW HEAD

WARNING!: Some of the metal parts might still be hot. Do not touch them with your hands until they have cooled.

1. Turn unit Off (“O”) using the On/Off switch and unplug the power cord from the electrical outlet.
2. Remove the porta-filter and discard the espresso grounds. Rinse the portafilter and filter with warm water.

NOTE: The porta-filter and filters are not dishwasher safe.

3. Attach the porta-filter (without coffee grounds) back onto the unit.
4. Make sure there is water in the water reservoir.
5. Place a large empty cup under the porta-filter and brew a single shot of espresso.

NOTE: When completed, do not store the porta-filter by leaving attached to the unit. This can adversely affect the seal between the brew head and the porta-filter when brewing espresso.

CLEANING THE WATER RESERVOIR

Discard the remaining water by removing the reservoir and turning it upside down over the sink. It is recommended to empty the water reservoir between uses. Wash the water reservoir with soapy water, rinse it well and wipe it dry. Do not wash the water reservoir in the dishwasher.

DEEP CLEANING THE FILTER

Make sure to deep clean your filter every 90 days for optimal brewing performance. Follow these disassembly instructions and rinse the pieces in a large bowl of warm water. Once rinsed thoroughly, wipe dry and reassemble.

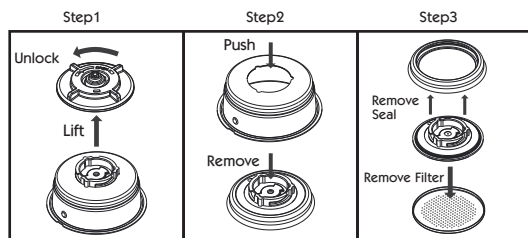

CLEANING THE UNIT

1. Wipe housing with a soft wet cloth. Do not use abrasive cleaners or scouring pads, as they will scratch the finish.
2. Do not store the porta-filter in the brew head. This can adversely affect the seal between the brew head and the porta-filter while brewing espresso.

CAUTION: Do not immerse appliance in water or other liquids.

DELMING

Mineral deposits built-up in the unit will affect the operation of the appliance. Your appliance must be delimed when you begin to notice an increase in the time required to brew espresso, or when there is excessive steaming. Also, you may notice a build-up of white deposits on the surface of the brew head. The frequency of cleaning depends upon the hardness of the water used. The following table gives the suggested cleaning intervals.

SUGGESTED CLEANING INTERVALS

Type of Water	Cleaning Frequency
Soft Water (Filtered Water)	Every 80 Brew Cycles
Hard Water (Tap Water)	Every 40 Brew Cycles

TO DELIME WATER RESERVOIR:

1. Fill the reservoir with fresh, undiluted white household vinegar.
2. Allow appliance to sit overnight with the vinegar solution in the water reservoir.
3. Discard vinegar by removing the reservoir and turning it upside down over the sink.
4. Rinse the water reservoir thoroughly with tap water by filling tank half full with water and then pouring the water back out into the sink, repeating this step twice.

TO DELIME INTERNAL PARTS:

1. Make sure you delime the inside of the water reservoir first by following the "Deliming" steps above.
2. Make sure to switch the on/off button to the off "O" position and the power cord is disconnected from the electrical outlet. Fill the reservoir half way with white vinegar.
3. Insert the porta-filter (with filter and no coffee) and place jar/carafe or regular cup on top of the drip tray and under the porta-filter.
4. Plug the power cord into the electrical outlet.
5. Press the on/off button to switch the unit on "I", once the 3 control panel illuminates solidly, press the the Espresso/Custom Button twice. The vinegar will start flowing through the unit and it will stop automatically.
6. Place a pitcher or large cup (with at least 325 mL/ 11-ounce capacity) under the tube. Fill the milk reservoir with water and place it back on the unit. Turn the Froth Control Knob clockwise to the clean position "Clean" then press the latte/clean button for 3 seconds to activate the clean function. The unit will start releasing steam through the frothing tube for 30 seconds. When done, throw the contents of the cup away.
7. Repeat Steps 1 – 6 as necessary using only tap water to rinse any remaining traces of vinegar out of the machine.

TROUBLESHOOTING YOUR MR. COFFEE® CAFÉ BARISTA COFFEE MAKER

PROBLEM	CAUSES	SOLUTIONS
Coffee does not come out.	<ul style="list-style-type: none"> • No water in reservoir. • Coffee grind is too fine. • Too much coffee in the filter. • Appliance was not turned on or plugged in. • Coffee has been tamped/ compressed too much. • Filter could be clogged. 	<ul style="list-style-type: none"> • Add water. • Grind medium ground coffee. • Fill filter with less coffee. • Plug unit into electrical outlet and turn it on. • Refill filter basket with coffee DO NOT TAMP too much. • Follow the instructions to deep clean the filter.
Coffee comes out around the edge of the porta-filter.	<ul style="list-style-type: none"> • Porta-filter not rotated to full lock position. • Coffee grounds around the filter basket rim. • Too much coffee in the filter. 	<ul style="list-style-type: none"> • Rotate filter holder to full lock position. • Wipe off rim and shower head seal. • Fill with less coffee.
Milk is not foamy after frothing or it is not coming out of the frothing tube.	<ul style="list-style-type: none"> • Ran out of steam. • Milk is not cold enough. • Frothing tube is blocked. 	<ul style="list-style-type: none"> • Ensure there is enough water in the water reservoir. • Chill milk and frothing pitcher prior to making cappuccino or latte. • Follow the instructions to clean the milk reservoir & frothing tube.
Coffee comes out too quickly.	<ul style="list-style-type: none"> • Ground coffee is too coarse. • Not enough coffee in filter. 	<ul style="list-style-type: none"> • Use a finer grind. • Use more coffee.
Coffee is too weak.	<ul style="list-style-type: none"> • Using small filter for double shot of espresso. • Ground coffee is too coarse. 	<ul style="list-style-type: none"> • Use large filter for double shot of espresso. • Use a finer grind.
The three control panel lights are flashing alternately.	<ul style="list-style-type: none"> • Water tank is out of water. 	<ul style="list-style-type: none"> • Add water to reservoir.
Cappuccino and/or Latte control button lights do not illuminate.	<ul style="list-style-type: none"> • Milk Reservoir not inserted. • Milk Reservoir not fully inserted. 	<ul style="list-style-type: none"> • Place Milk Reservoir on unit. • If Milk Reservoir is on unit, push in firmly until Cappuccino and Latte control button lights illuminate.
Water is not being pulled in from the water reservoir.	<ul style="list-style-type: none"> • Red plug was not removed from base of water reservoir tank. • Water reservoir tank not placed correctly on unit. 	<ul style="list-style-type: none"> • Remove red plug from base of water reservoir tank. Red plug may also be found in hole on unit where water reservoir attaches at its base. • Place water reservoir correctly.

Do you still have questions? You can call us toll-free at the Consumer Service Department, 1-800-MR COFFEE (1-800-672-6333) or you can visit us at www.mrcoffee.com.

SERVICE AND MAINTENANCE

Replacement Parts

- For other replacement parts – Call 1-800-MR COFFEE (1-800-672-6333) in the U.S. or 1-800-667-8623 in Canada. You may also find a list of replacement parts at www.mrcoffeebarista.com.

Repairs

If your Café Barista (espresso, cappuccino & latte maker) requires service, do not return it to the store where you purchased it. All repairs and replacements must be made by Sunbeam or by an authorized MR. COFFEE® Products Service Center. If you live in the U.S. or Canada, please call us at the following toll-free telephone numbers to find the location of the nearest authorized service center:

U.S. 1-800-MR COFFEE (1-800-672-6333)

Canada 1-800-667-8623

You may also visit our website at www.mrcoffee.com for a list of service centers. To assist us in serving you, please have the model number and date of purchase available when you call. The model number is on the bottom of the unit.

We welcome your questions, comments or suggestions. In all your communications, please include your complete name, address and telephone number and a description of the problem.

1-YEAR LIMITED WARRANTY

Sunbeam Products, Inc. doing business as Jarden Consumer Solutions or if in Canada, Sunbeam Corporation (Canada) Limited doing business as Jarden Consumer Solutions (collectively "JCS") warrants that for a period of one year from the date of purchase, this product will be free from defects in material and workmanship. JCS, at its option, will repair or replace this product or any component of the product found to be defective during the warranty period. Replacement will be made with a new or remanufactured product or component. If the product is no longer available, replacement may be made with a similar product of equal or greater value. This is your exclusive warranty. Do NOT attempt to repair or adjust any electrical or mechanical functions on this product. Doing so will void this warranty.

This warranty is valid for the original retail purchaser from the date of initial retail purchase and is not transferable. Keep the original sales receipt. Proof of purchase is required to obtain warranty performance. JCS dealers, service centers, or retail stores selling JCS products do not have the right to alter, modify or any way change the terms and conditions of this warranty.

This warranty does not cover normal wear of parts or damage resulting from any of the following: negligent use or misuse of the product, use on improper voltage or current, use contrary to the operating instructions, disassembly,

repair or alteration by anyone other than JCS or an authorized JCS service center. Further, the warranty does not cover: Acts of God, such as fire, flood, hurricanes and tornadoes.

What are the limits on JCS's Liability?

JCS shall not be liable for any incidental or consequential damages caused by the breach of any express, implied or statutory warranty or condition.

Except to the extent prohibited by applicable law, any implied warranty or condition of merchantability or fitness for a particular purpose is limited in duration to the duration of the above warranty.

JCS disclaims all other warranties, conditions or representations, express, implied, statutory or otherwise.

JCS shall not be liable for any damages of any kind resulting from the purchase, use or misuse of, or inability to use the product including incidental, special, consequential or similar damages or loss of profits, or for any breach of contract, fundamental or otherwise, or for any claim brought against purchaser by any other party.

Some provinces, states or jurisdictions do not allow the exclusion or limitation of incidental or consequential damages or limitations on how long an implied warranty lasts, so the above limitations or exclusion may not apply to you.

This warranty gives you specific legal rights, and you may also have other rights that vary from province to province, state to state or jurisdiction to jurisdiction.

How to Obtain Warranty Service

In the U.S.A.

If you have any question regarding this warranty or would like to obtain warranty service, please call 1-800-672-6333 and a convenient service center address will be provided to you.

In Canada

If you have any question regarding this warranty or would like to obtain warranty service, please call 1-800-667-8623 and a convenient service center address will be provided to you.

In the U.S.A., this warranty is offered by Sunbeam Products, Inc. doing business as Jarden Consumer Solutions located in Boca Raton, Florida 33431. In Canada, this warranty is offered by Sunbeam Corporation (Canada) Limited doing business as Jarden Consumer Solutions, located at 20 B Hereford Street, Brampton, Ontario L6Y 0M1. If you have any other problem or claim in connection with this product, please write our Consumer Service Department.

PLEASE DO NOT RETURN THIS PRODUCT TO ANY OF THESE ADDRESSES OR TO THE PLACE OF PURCHASE.

PRECAUCIONES IMPORTANTES

Para disminuir el riesgo de incendios, descargas eléctricas o lesiones personales, se deben seguir siempre las precauciones básicas de seguridad al utilizar artefactos eléctricos, incluyendo las siguientes:

1. **LEA TODAS LAS INSTRUCCIONES ANTES DE UTILIZAR EL ELECTRODOMÉSTICO.**
2. No toque las superficies calientes. Utilice las asas o las perillas.
3. Para protegerse contra descargas eléctricas, no sumerja el cable, el enchufe ni el electrodoméstico en agua ni en ningún otro líquido.
4. Desenchufe la unidad del tomacorriente cuando no esté en uso y antes de limpiarlo. Deje que se enfríe antes de colocar o sacar piezas y antes de limpiar el electrodoméstico.
5. No utilice un electrodoméstico que tenga un cable o un enchufe dañado, ni después de que el artefacto haya presentado fallas, o haya sufrido cualquier otro daño. Devuelva el artefacto al Centro de Servicio Autorizado MR. COFFEE® más cercano para su inspección, reparación o ajuste. No intente reemplazar o ajustar un cable dañado.
6. El uso de un accesorio en el artefacto no recomendado por el fabricante del artefacto, puede provocar un incendio, descargas eléctricas o lesiones a las personas.
7. No utilice en exteriores ni para fines comerciales.
8. No deje que el cable cuelgue del borde de la mesa o el mostrador, ni que entre en contacto con superficies calientes.
9. No coloque este artefacto sobre un quemador caliente, ni cerca de él, ya sea de gas o eléctrico, ni dentro de un horno caliente.
10. Para desconectar, oprima el interruptor ubicado al lado de la unidad en la posición "O" y luego desconecte del tomacorriente.
11. No utilice este artefacto para fines distintos a los recomendados.
12. Coloque sobre una superficie plana y nivelada para evitar interrumpir el flujo de aire por debajo del electrodoméstico.
13. Asegúrese siempre de volver a colocar con firmeza el tanque de agua en la unidad con la tapa cerrada y con agua, pero que no sobrepase la línea MAX.
14. No saque el porta-filtro mientras esté colando café. Verifique que las tres luces estén encendidas antes de sacar el porta-filtro para hacer café nuevamente. Asimismo, debe tener precaución al sacar el porta-filtro ya que las piezas metálicas estarán calientes. Asegúrese de sujetarlo por el asa y de utilizar el gancho de retención del filtro para desechar el café molido usado. Debe tener precaución al mover la unidad con líquidos calientes.
15. No quite el tanque de agua ni el de leche hasta que la unidad haya dejado de preparar o dar vapor a la leche.
16. Este artefacto no debe ser utilizado por niños o por personas con capacidades físicas, sensoriales o mentales reducidas.
17. Se requiere una estricta supervisión cuando el artefacto se usa cerca de niños. Los niños no deben jugar con el artefacto.

CONSERVE ESTAS INSTRUCCIONES

ESTA UNIDAD ESTÁ DISEÑADA SOLO PARA USO DOMÉSTICO.

INSTRUCCIONES PARA EL CABLE ELÉCTRICO

1. Se proporciona un cable de alimentación corto para disminuir los peligros originados por enredos o tropiezos con cables largos.
2. Se puede comprar y utilizar una extensión si se emplean las debidas precauciones.
3. Si se usa un cable de extensión, La capacidad eléctrica del cable de extensión debe ser al menos tan alta como la capacidad eléctrica del artefacto. La extensión deberá colocarse de forma que no cuelgue de la mesa o la encimera donde un niño podría jalarla o tropezarse con ella por accidente.

ENCHUFE POLARIZADO



Este electrodoméstico tiene un enchufe polarizado (un contacto es más ancho que el otro). Para reducir el riesgo de descargas eléctricas, como una función de seguridad, este enchufe está diseñado para encajar en un tomacorriente polarizado solo de una forma. Si el enchufe no se inserta completamente en el tomacorriente, invierta el enchufe. Si aún no encaja, consulte a un electricista calificado. No intente ignorar esta medida de seguridad ni modificar el enchufe en forma alguna. Si el enchufe se inserta holgadamente en el tomacorriente de corriente alterna o si el tomacorriente de corriente alterna se siente caliente, no utilice ese tomacorriente.

USO DEL CAFÉ MOLIDO ADECUADO PARA CAFETERAS DE ESPRESSO

No utilice café molido tostado con azúcar (*) ni granos de café tostados con azúcar ya que estos obstruirán el filtro y dañarán el electrodoméstico. Si se usa accidentalmente café molido tostado con azúcar, suspenda el uso de la unidad y llévela al centro de servicio más cercano para darle mantenimiento.

Recomendamos eliminar periódicamente los residuos minerales acumulados en la máquina para mantener su buen funcionamiento. Comuníquese con nosotros al número gratuito del Departamento de Servicio al Consumidor 1-800-MR COFFEE (1-800-672-6333) para conocer el proceso.

(*) MOLIDO CON AZÚCAR

CONTENIDO

Precauciones importantes	21
Descripcion del aparato	24
Introducción	26
Antes de usar el aparato por primera vez	27
Cómo seleccionar el café adecuado	28
Instrucciones para el funcionamiento	29
Limpieza de Su cafetera Mr. Coffee® Café Barista	34
Solución de problemas de Su cafetera Mr. Coffee® Café Barista	37
Reparación y mantenimiento	38
Información de garantía	39