



**READ BEFORE USE**  
**LIRE AVANT UTILISATION**  
**LEA ANTES DE USAR**

hamiltonbeach.com  
 For recipes, tips and product information.

hamiltonbeach.ca  
 Pour des recettes, des conseils et des renseignements sur le produit.

hamiltonbeach.com.mx  
 Para recetas, consejos e información del producto.



**ENTER TO WIN \$100  
 TO SPEND ON WEBSITE**  
 Scan code or visit  
[register.hamiltonbeach.com](http://register.hamiltonbeach.com)

**PARTICIPEZ POUR COURIR LA CHANCE DE  
 GAGNER UN MONTANT DE 100 \$  
 À DÉPENSER SUR NOTRE SITE WEB**  
 Balayez le code ou visitez le  
[register.hamiltonbeach.com](http://register.hamiltonbeach.com)

**INGRESE PARA TENER LA OPORTUNIDAD  
 DE GANAR \$100 PARA GASTAR EN  
 NUESTRO SITIO WEB**  
 Escanee el código o visite  
[register.hamiltonbeach.com](http://register.hamiltonbeach.com)

Open to US customers only • Ce concours  
 s'adresse aux clients des États-Unis seulement  
 • Este concurso está disponible sólo a clientes  
 de los Estados Unidos

*Le invitamos a leer cuidadosamente este  
 instructivo antes de usar su aparato.*

# Hamilton Beach®



Coffee Maker  
 Cafetière  
 Cafetera

English .....	2
Français .....	10
Español .....	19



# IMPORTANT SAFEGUARDS

When using electrical appliances, basic safety precautions should always be followed to reduce the risk of fire, electric shock, and/or injury to persons, including the following:

1. Read all instructions.
2. This appliance is not intended for use by persons (including children) with reduced physical, sensory, or mental capabilities, or lack of experience and knowledge, unless they are closely supervised and instructed concerning use of the appliance by a person responsible for their safety.
3. Close supervision is necessary when any appliance is used by or near children. Cleaning and user maintenance shall not be made by children without supervision. Children should be supervised to ensure that they do not play with the appliance.
4. Do not touch hot surfaces. Use handles or knobs. Care must be taken as burns can occur from touching hot parts or from spilled, hot liquid.
5. To protect against electric shock, do not place cord, plug, or coffee maker in water or other liquid.
6. Unplug from outlet when either the coffee maker or clock is not in use and before cleaning. To unplug, grasp the plug and pull from the outlet. Never pull from the power cord. Allow to cool before putting on or taking off parts and before cleaning the appliance.
7. Coffee maker must be operated on a flat surface away from the edge of counter to prevent accidental tipping.
8. The use of accessory attachments not recommended by the appliance manufacturer may cause injuries.
9. Do not operate any appliance with a damaged supply cord or plug, or after the appliance malfunctions or has been dropped or damaged in any manner. Supply cord replacement and repairs must be conducted by the manufacturer, its service agent, or similarly qualified persons in order to avoid a hazard. Contact Customer Service for information on examination, repair, or adjustment as set forth in the Limited Warranty.
10. Do not use outdoors.
11. Do not let cord hang over edge of table or counter or touch hot surfaces, including the stove.
12. Do not place coffee maker on or near a hot gas or electric burner or in a heated oven.
13. To disconnect coffee maker, turn controls to OFF (O) and then remove plug from wall outlet. To unplug, grasp the plug and pull from the outlet. Never pull from the power cord.
14. Scalding may occur if the lid is removed during the heating cycle.
15. Do not use appliance for other than intended use.
16. **WARNING!** To reduce the risk of fire or electric shock, do not remove the bottom cover. No user-serviceable parts are inside. Repair should be done by authorized service personnel only.
17. Use only the carafe provided with the appliance.
18. The carafe is designed for use with this coffee maker. It must never be used on a range top or in a microwave oven.
19. Do not set hot carafe on a wet or cold surface.
20. Do not use a cracked carafe or one with a loose or weakened handle.
21. Do not clean carafe with cleansers, steel wool pads, or other abrasive materials.
22. Be certain carafe lid is securely in place during brew cycle and when pouring coffee. Do not use force when placing lid on carafe.
23. Do not place coffee maker in a cabinet when in use.

## SAVE THESE INSTRUCTIONS

### Other Consumer Safety Information

**This appliance is intended for household use only.**

**⚠ WARNING Electrical Shock Hazard:** This appliance is provided with a polarized plug (one wide blade) to reduce the risk of electric shock. The plug fits only one way into a polarized outlet. Do not defeat the safety purpose of the plug by modifying the plug in any way or by using an adapter. If the plug does not fit fully into the outlet, reverse the plug. If it still does not fit, have an electrician replace the outlet.

The length of the cord used on this appliance was selected to reduce the hazards of becoming tangled in or tripping over a longer cord. If a longer cord is necessary, an approved extension cord may be used. The electrical rating of the extension cord must be equal to or greater than the rating of the appliance. Care must be taken to arrange the extension cord so that it will not drape over the countertop or tabletop where it can be pulled on by children or accidentally tripped over. To avoid an electrical circuit overload, do not use another high-wattage appliance on the same circuit with this appliance.

# Parts and Features

To order parts, visit:  
[hamiltonbeach.com/parts](http://hamiltonbeach.com/parts)

**BEFORE FIRST USE:** Wash carafe, removable filter basket and grounds filter parts in hot, soapy water. Rinse and dry. Brew one cycle with water and discard water.

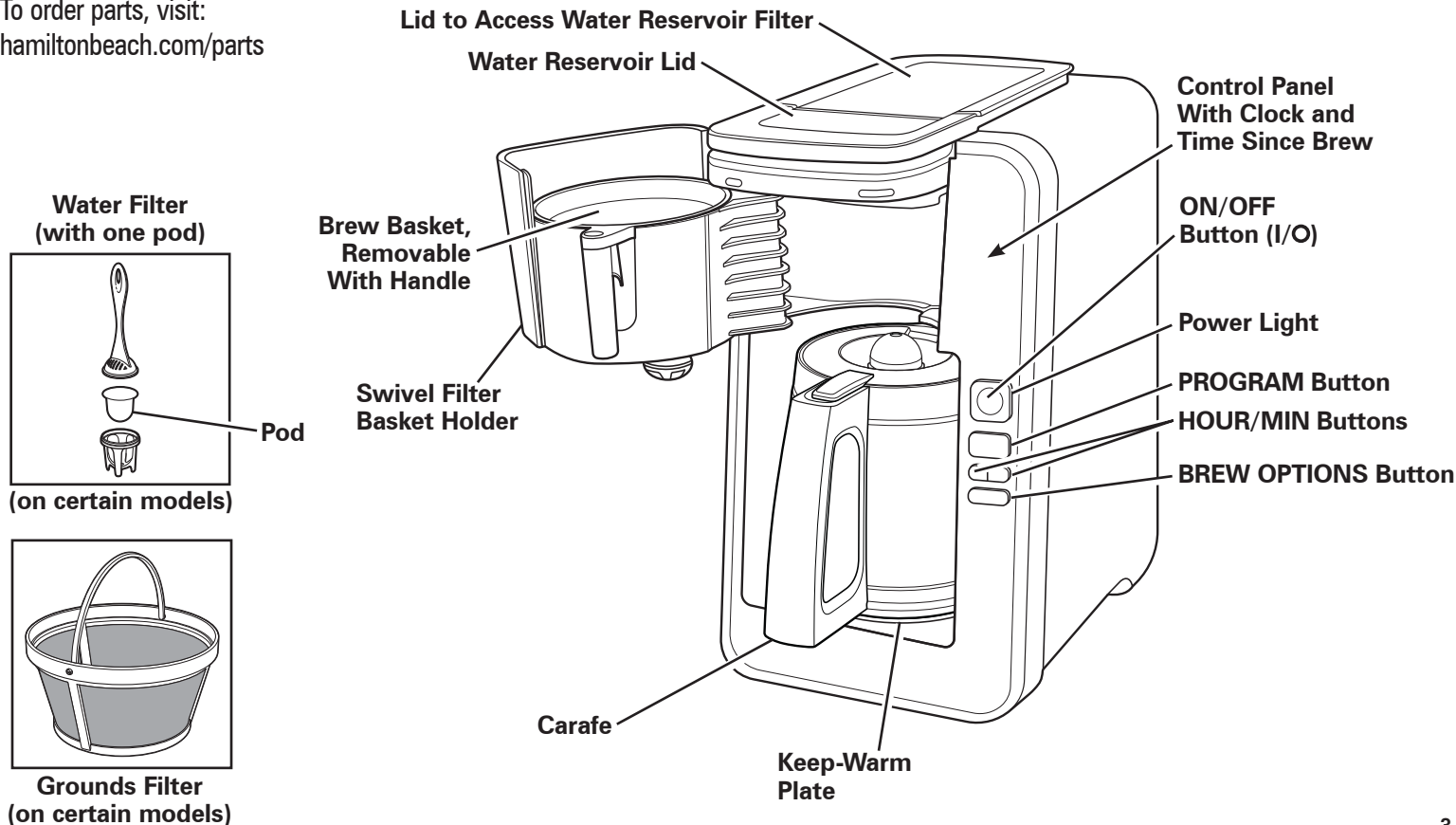

# How to Make Coffee

## **⚠ WARNING Burn Hazard.**

To avoid hot coffee overflowing from the filter basket:

- When using decaffeinated coffee, do not exceed the coffee manufacturer's recommended serving amount.
- Ensure swivel filter basket is completely closed.

If filter basket overflow occurs, unplug coffee maker and allow coffee in filter basket to cool before removing filter basket.

## **⚠ WARNING Electrical Shock Hazard.**

Do not immerse cord, plug, or coffee maker in any liquid.

1. Plug into outlet.
2. Press and release **HOURL** button. Time will flash in display. Press and hold or pulse **HOURL** button to set current hour in AM or PM.

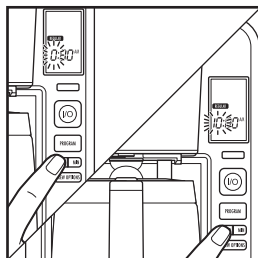

3. Press and hold or pulse **MIN** button within 3 seconds to set current minutes. Set time will display constant in 3 seconds.
4. Fill carafe with water; lift water reservoir lid to add water.
5. Pull swivel filter basket holder to open.
6. Add grounds filter.

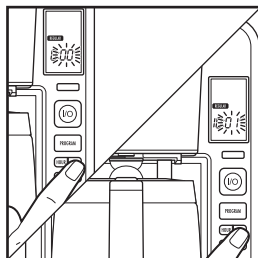

7. For each cup of coffee being made, place one level tablespoon (5 g) of ground coffee into filter.
8. Close swivel filter basket holder before brewing, and do not open until brewing cycle is complete and unit is cool.

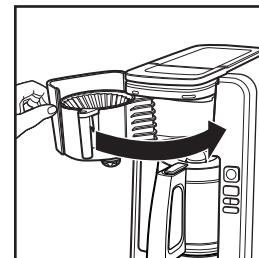

9. Select brew option. Default is **REGULAR**. Choose **BOLD** for stronger coffee or **1-4 CUPS** for smaller quantity.
10. Press **I/O (ON/OFF)** button once to turn on the coffee maker and button will illuminate. The **TIME SINCE BREW** Freshness Timer will illuminate once the brew cycle begins. It will continue to count up after the brewing is complete and keep your coffee warm until the auto shutoff at 2 hours. When all coffee has been served, press **I/O (ON/OFF)** button once and unplug. **NOTE:** If the coffee maker is not turned off manually, it will automatically shut off in 2 hours and the light will turn off.

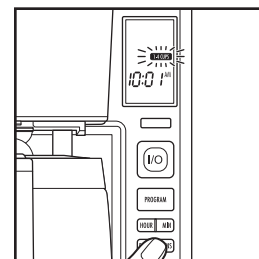

# To Program Automatic Brew

**NOTE:** White LED comes on to indicate PROGRAM is activated. White LED light goes off when the unit begins to brew at the preprogrammed time.

1. Choose a brew option.
2. Press and hold the **PROGRAM** button until the **PROGRAM** light flashes.
3. With **PROGRAM** light flashing and **START TIME** displayed, press **HOUR** and **MIN** buttons to set the desired brew time.
4. After 2 seconds, the light will stop flashing. Programmed time will be stored and the current time will be displayed.
5. Press and release **PROGRAM** button again to activate automatic brew. **PROGRAM** light comes on.

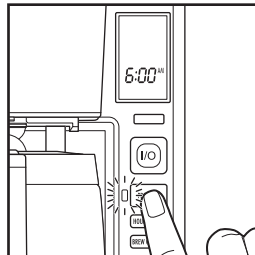
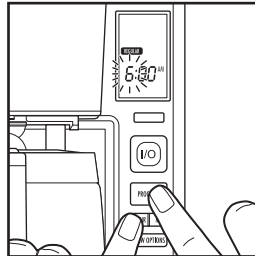
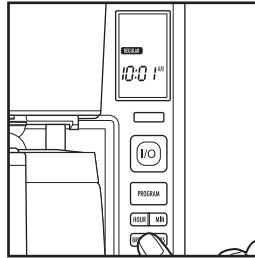

# Tips for Best-Tasting Coffee

- All coffees are made from either arabica beans or robusta beans, or some combination of both. Arabica beans are slightly more expensive, but tend to produce better-tasting coffee.
- Ground coffee will become stale much faster than whole beans. If buying preground coffee, choose a package with the latest expiration date or a smaller quantity.
- If grinding whole beans, set your coffee grinder on a fine/medium grind. This will yield the best-tasting grounds. Try to use freshly ground coffee within about a week of grinding.
- Using a water filter, filtered water, or bottled water will yield better-tasting coffee than tap water.
- Use approximately 1 tablespoon (5 g) of grounds for each cup of coffee being made. To avoid overflow, use about 1/3 less grounds when brewing decaf or flavored coffees.
- Make sure your coffee maker is clean. See "Care and Cleaning" section.

# Care and Cleaning

## **⚠ WARNING Electrical Shock Hazard.**

Do not immerse cord, plug, or coffee maker in any liquid.

All coffee makers should be cleaned at least once a month (once a week for areas with hard water). Press **BREW OPTIONS** button to select **CLEAN**.

1. Unplug. (This resets brew counter for cleaning mode notification.)
2. Wipe coffee maker with a damp cloth or sponge. Dry.
3. Remove water filter and pod (see "How to Replace the Water Filter").
4. Pour a minimum of 1 pint (2 cups/473 ml) white vinegar into water reservoir.
5. Plug in and press the **I/O (ON/OFF)** button once. **CLEAN** will flash in the display and white LED will illuminate. When **CLEAN** cycle is finished, wait for unit to cool. Clean cycle takes about 35 minutes to complete.
6. Empty carafe and rinse. Press **BREW OPTIONS** to select **REGULAR**. Run 2–3 more brew cycles with **CLEAN WATER** only. Allow to cool between cycles.
7. The carafe, filter basket, and grounds filter are dishwasher-safe to wash and dry in the **TOP RACK** only.  
DO NOT use the "SANI" setting on dishwasher. "SANI" cycle temperatures could damage your product.

## Clean Notification

If unit is always plugged in, after 30 cycles **CLEAN** will show in the display. Follow the directions for "Care and Cleaning."

### **NOTES:**

- Performing the cleaning procedure will clear the display.
- The brew cycle counter resets every time the coffee maker is unplugged or when power is lost.

If you do not want to perform the cleaning procedure, press the **I/O (ON/OFF)** button two times to clear the display.

## Water Filter Notification

- If unit is always plugged in, after 60 cycles **WATER FILTER** will show in the display. Follow directions for "How to Replace Water Filter."
- The brew cycle counter resets every time the coffee maker is unplugged or when power is lost.

# How to Replace the Water Filter

1. Soak filter pod for 15 minutes in water.

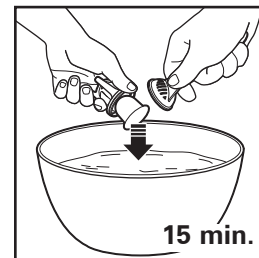

2. Add pod to bottom of water filter and snap on filter handle.
3. Place assembly into right side of water reservoir.

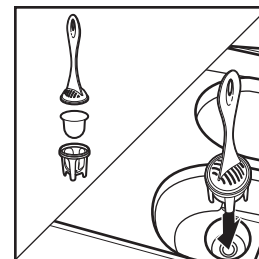

For better-tasting coffee, use a water filter.

**NOTE:** **CLEAN** and **WATER FILTER** notifications will remain in display for two additional brew cycles and turn off automatically.

# Carafe Safety Precautions

- Do not use a cracked carafe or a carafe having a loose or weakened handle.
- This carafe is designed to be used only on the keep-warm plate of your coffee maker. Do not use on a gas or electric rangetop, or in a microwave or conventional oven.
- To avoid breakage, handle carafe with care. Avoid impact. Glass will break as a result of impact. Use care when filling with water to avoid hitting faucet.
- Do not place hot carafe on cool or wet surface. Allow to cool before washing or adding liquids.
- Do not set empty carafe on a hot heating surface.
- Do not clean with steel wool pads, abrasive cleanser, or any other materials that may scratch.



This symbol alerts you to the potential danger for personal injury if you fail to read and follow these safety precautions.



This symbol reminds you that glass is fragile and can break which could result in personal injury.

- Do not place hands inside carafe. When handling, be careful if wearing any hand jewelry, especially diamond rings. Jewelry can scratch the glass, which increases possibility of breakage.
- Do not bump, scratch, or boil dry.
- Discard carafe if it is cracked, scratched, or heated while empty for an extended period of time.
- To avoid accidents, do not pour in the direction of people.
- If stirring in the carafe, use only wooden, plastic, or rubber utensils. Do not use metal utensils.
- Follow the above safety precautions carefully to avoid serious burn injuries which may result if breakage occurs while carafe holds heated liquids.

# Troubleshooting

## **Filter basket overflows or coffee brews slowly.**

- The BOLD or 1–4 CUPS brew option is recommended for brewing decaffeinated coffee.
- Excessive amounts of coffee.
- Coffee ground too finely (not automatic drip grind).
- Carafe not securely placed on keep-warm plate or swivel filter basket holder not closed completely.
- Carafe removed during brewing for more than 20 seconds and not placed securely back on keep-warm plate.
- Coffee maker needs cleaning.
- Coffee grounds between grounds filter and filter basket.
- Rinse filter basket before inserting paper filter so the edges will remain pressed against the sides of the basket.
- Poor-quality paper filter.

## **Coffee not brewing/unit will not turn on.**

- Water reservoir is empty.
- Unit is unplugged.
- Power outage.
- Power surge. Unplug; then plug the unit back in.
- Clock requires reset after power outage.



# Limited Warranty

This warranty applies to products purchased and used in the U.S. and Canada. This is the only express warranty for this product and is in lieu of any other warranty or condition.

This product is warranted to be free from defects in material and workmanship for a period of five (5) years from the date of original purchase in Canada and one (1) year from the date of original purchase in the U.S. During this period, your exclusive remedy is repair or replacement of this product or any component found to be defective, at our option; however, you are responsible for all costs associated with returning the product to us and our returning a product or component under this warranty to you. If the product or component is no longer available, we will replace with a similar one of equal or greater value.

This warranty does not cover glass, filters, wear from normal use, use not in conformity with the printed directions, or damage to the product resulting from accident, alteration, abuse, or misuse. This warranty extends only to the original consumer purchaser or gift recipient. Keep the original sales receipt, as proof of purchase is required to make a warranty claim. This warranty is void if the product is used for other than single-family household use or subjected to any voltage and waveform other than as specified on the rating label (e.g., 120 V ~ 60 Hz).

We exclude all claims for special, incidental, and consequential damages caused by breach of express or implied warranty. All liability is limited to the amount of the purchase price. **Every implied warranty, including any statutory warranty or condition of merchantability or fitness for a particular purpose, is disclaimed except to the extent prohibited by law, in which case such warranty or condition is limited to the duration of this written warranty.** This warranty gives you specific legal rights. You may have other legal rights that vary depending on where you live. Some states or provinces do not allow limitations on implied warranties or special, incidental, or consequential damages, so the foregoing limitations may not apply to you.

To make a warranty claim, do not return this appliance to the store. Please write Hamilton Beach Brands, Inc., Customer Service Department, 4421 Waterfront Dr., Glen Allen, VA 23060, or visit [hamiltonbeach.com/customer-service](http://hamiltonbeach.com/customer-service) in the U.S. or [hamiltonbeach.ca/customer-service](http://hamiltonbeach.ca/customer-service) in Canada. For faster service, locate the model, type, and series numbers on your appliance.